

3 1/2 ZI - WOHNUNG	1.DG
BAHNHOFSTRASSE 80	73
" " 82	81
" " 88	105
" " 90	113
NETTO - WOHNUNGSFLÄCHE	101m ²

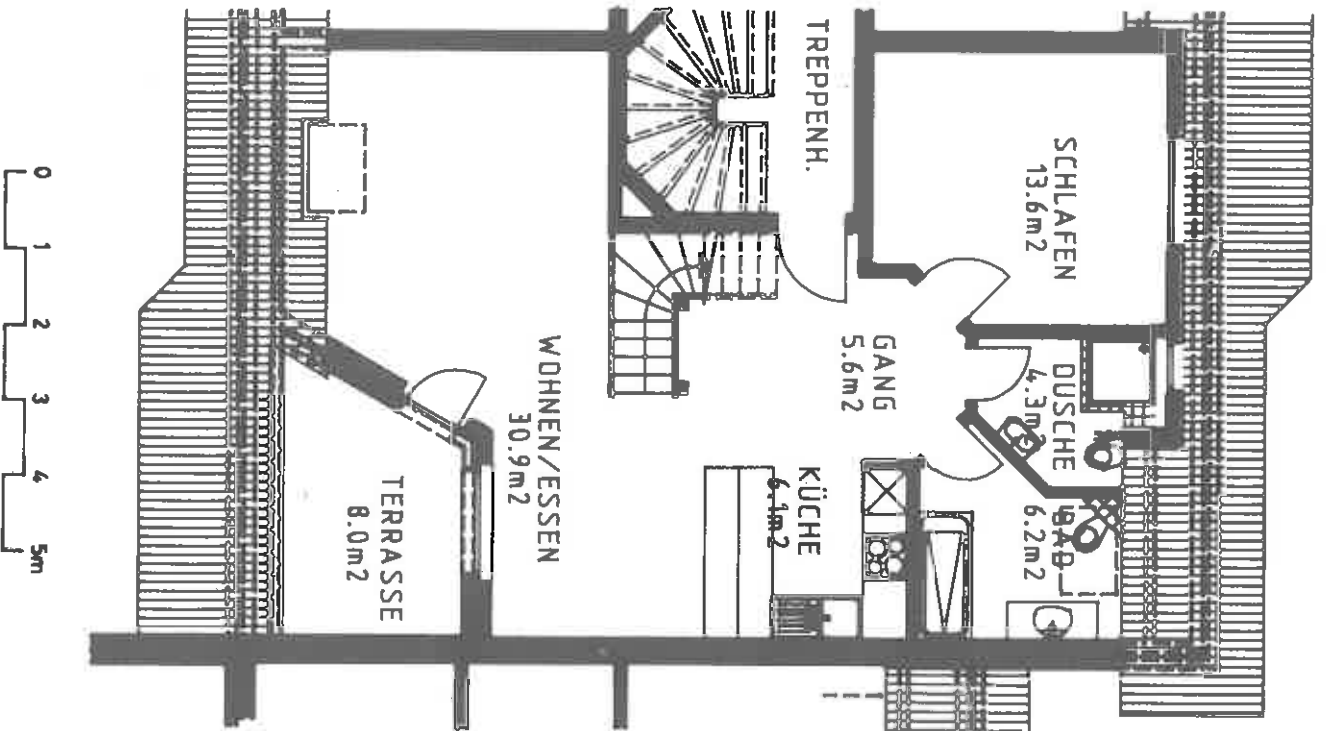

3 1/2 ZI - WOHNUNG	2.DG
BAHNHOFSTRASSE 80	73
" 82	81
" 88	105
" 90	113

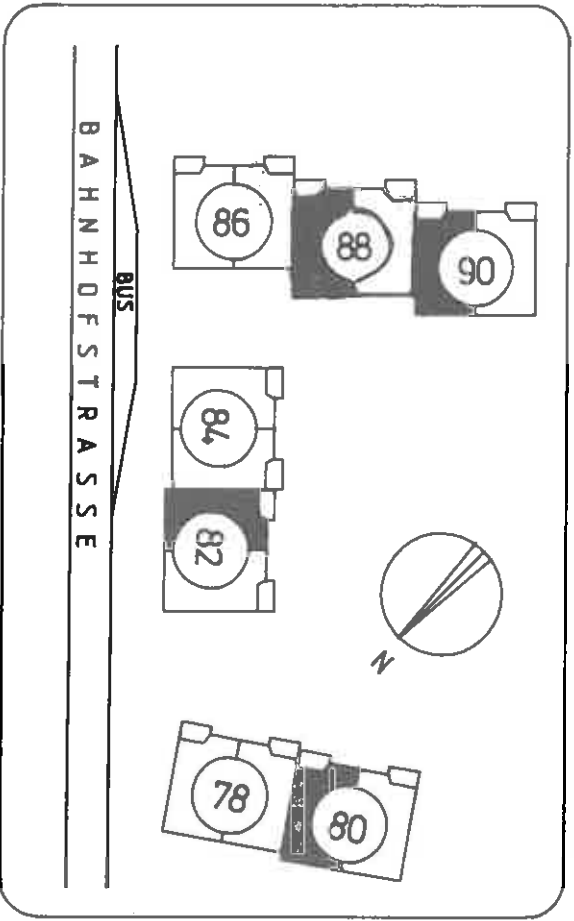